

CUPE 382 Internal Vacancy

Posting Bulletin 26-12

–June 4, 2026–

Listed below is a summary of the vacancies that are currently posted at Human Resources. Only the unique details for each posting are listed below.

Individuals wishing to apply for any of the competitions are urged to view the Qualifications and Job Descriptions for each position at your worksite or HRS. Applications from the present CUPE 382 staff will be received in Human Resources (**fax: 250-475-4113**) up to 4:00 p.m. on June 11, 2026, to fill these vacancies. Individuals can apply through eServices via the GVSD Staff Portal - <https://www.sd61.bc.ca/staff-support-portal/> An Internal [Application form](#) is also available in pdf format and can be sent to Human Resources.

(In order to view the on-line application form you must have [Adobe Acrobat Reader](#) installed.
Acrobat Reader is available free of charge.

| No. | Position | Location/ Term | Hours/ Week | Pay Grade | Close Date | Job Specific Details |
|--------|--------------|---|-------------|-----------|---------------|--|
| 26-24C | Custodian II | Colquitz 5:00 am – 1:30 pm | 40 | 10 | June 11, 2026 | Physically able to perform all duties included in the Job Characteristics; Must have a minimum of five years' janitorial experience; Must have the ability to plan and delegate work to other employees; Maintains a cooperative working relationship with other workers, supervisory and teaching staff, students and public. |
| 26-25C | Custodian II | Tillicum 5:00 am – 1:30 pm Start Date: Aug 31, 2026 | 40 | 10 | June 11, 2026 | Physically able to perform all duties included in the Job Characteristics; Must have a minimum of five years' janitorial experience; Must have the ability to plan and delegate work to other employees; Maintains a cooperative working relationship with other workers, supervisory and teaching staff, students and public. |
| 26-26C | Custodian I | Esquimalt 3:30 pm – 12:00 am Start Date: Sep 8, 2026 | 40 | 6 | June 11, 2026 | Physically able to perform all duties included in the Job Characteristics; Must have a minimum of five years' janitorial experience; Must have the ability to plan and delegate work to other employees; Maintains a cooperative working relationship with other workers, supervisory and teaching staff, students and public. |

NOTE: Current proof of qualifications must be in your employee file at Human Resource Services by the closing date of the competition for which you are applying.

IF YOU WOULD LIKE MORE INFORMATION REGARDING THESE VACANCIES, PLEASE CONTACT PRINCIPAL/SUPERVISOR

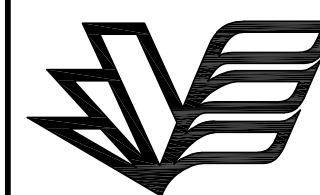

Greater
VICTORIA
School District

**COLQUITZ
MIDDLE
CUSTODIAL
RUNS**

505 Dumeresq St.
Victoria, B.C.
V8Z 1X3

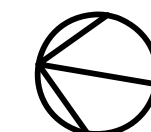

© copyright reserved
This drawing is the property of School
District #61 (Greater Victoria) and may not
be reproduced without their written consent.

| Issue no. | date | rev. description | by | ckd by |
|-----------|------|------------------|----|--------|
| | | | | |

Date : July, 2025

Scale : 1" = 40'-0"

Drawn By : JFG

Facility No. 61068

Bldg Area: 58,731 sqft

SR No. n/a

Drawing No. 1 of 1

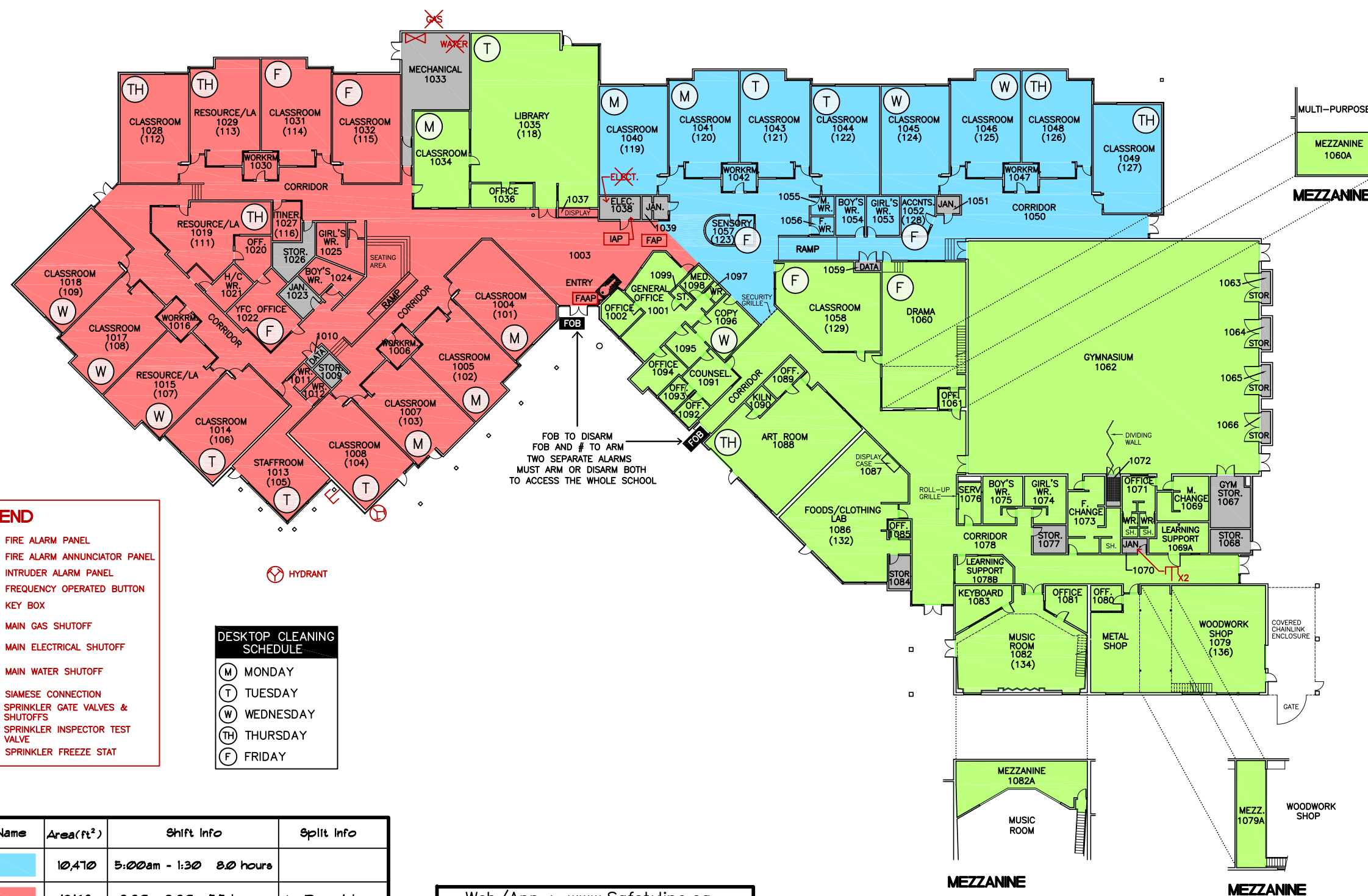

LEGEND

- FIRE ALARM PANEL
- FIRE ALARM ANNUNCIATOR PANEL
- INTRUDER ALARM PANEL
- FREQUENCY OPERATED BUTTON
- KEY BOX
- MAIN GAS SHUTOFF
- MAIN ELECTRICAL SHUTOFF
- MAIN WATER SHUTOFF
- SIAMESE CONNECTION
- SPRINKLER GATE VALVES & SHUTOFFS
- SPRINKLER INSPECTOR TEST VALVE
- SPRINKLER FREEZE STAT
- HYDRANT

DESKTOP CLEANING SCHEDULE

- MONDAY
- TUESDAY
- WEDNESDAY
- THURSDAY
- FRIDAY

| Run Name | Area(ft ²) | Shift Info | Split Info |
|----------|------------------------|-------------------------|---------------|
| C2 | 10,470 | 5:00am - 1:30 8.0 hours | |
| C1-a | 18,162 | 3:30 - 9:30 5.5 hours | to Reynolds |
| C1-b | 28,034 | 6:00 - 12:00 5.5 hours | from Spectrum |
| n/a | 2,065 | Not cleaned daily. | |

Web/App : www.Safetyline.ca
 Email Login : security+0068@sd61.bc.ca
 Password : Security+0068
 Phone : 1-866-913-3337 User ID : 0068
 Company : 116 Password : 0068

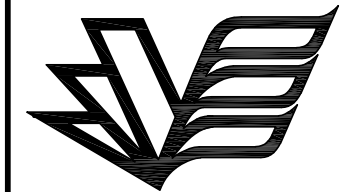

Greater
VICTORIA
School District

TILlicum
ELEMENTARY
CUSTODIAL
RUNS

3155 Albina St.
Victoria, B.C.
V9A 1Z6

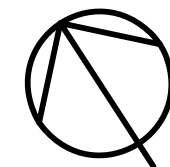

© copyright reserved
This drawing is the property of School
District #61 (Greater Victoria) and may not
be reproduced without their written consent.

| Issue no. | date | rev. description | by | chk by |
|-----------|------|------------------|----|--------|
| | | | | |

Date : Mar, 2024

Scale : 1" = 40'-0"

Drawn By : JPG

Facility No. 61020

Bldg Area 50,032 sqft

SR No.

Drawing No. 1 of 1

KEY PLAN
N.T.S.

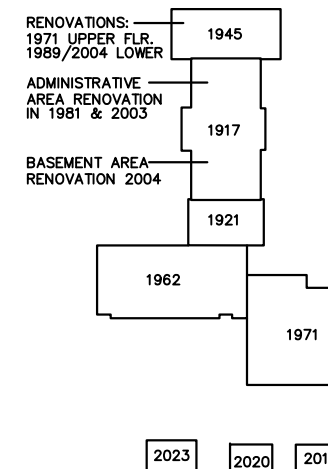

LEGEND

- FAP FIRE ALARM PANEL
- FAAP FIRE ALARM ANNUNCIATOR PANEL
- IAP INTRUDER ALARM PANEL
- FOB FREQUENCY OPERATED BUTTON
- KB KEY BOX
- ✕ MAIN GAS SHUTOFF
- ✕ ELECT. MAIN ELECTRICAL SHUTOFF
- ✕ WATER MAIN WATER SHUTOFF
- ⊗ SIAMESE CONNECTION
- ⊗ SPRINKLER GATE VALVES & SHUTOFFS
- T SPRINKLER INSPECTOR TEST VALVE
- * SPRINKLER FREEZE STAT

SECOND FLOOR PLAN

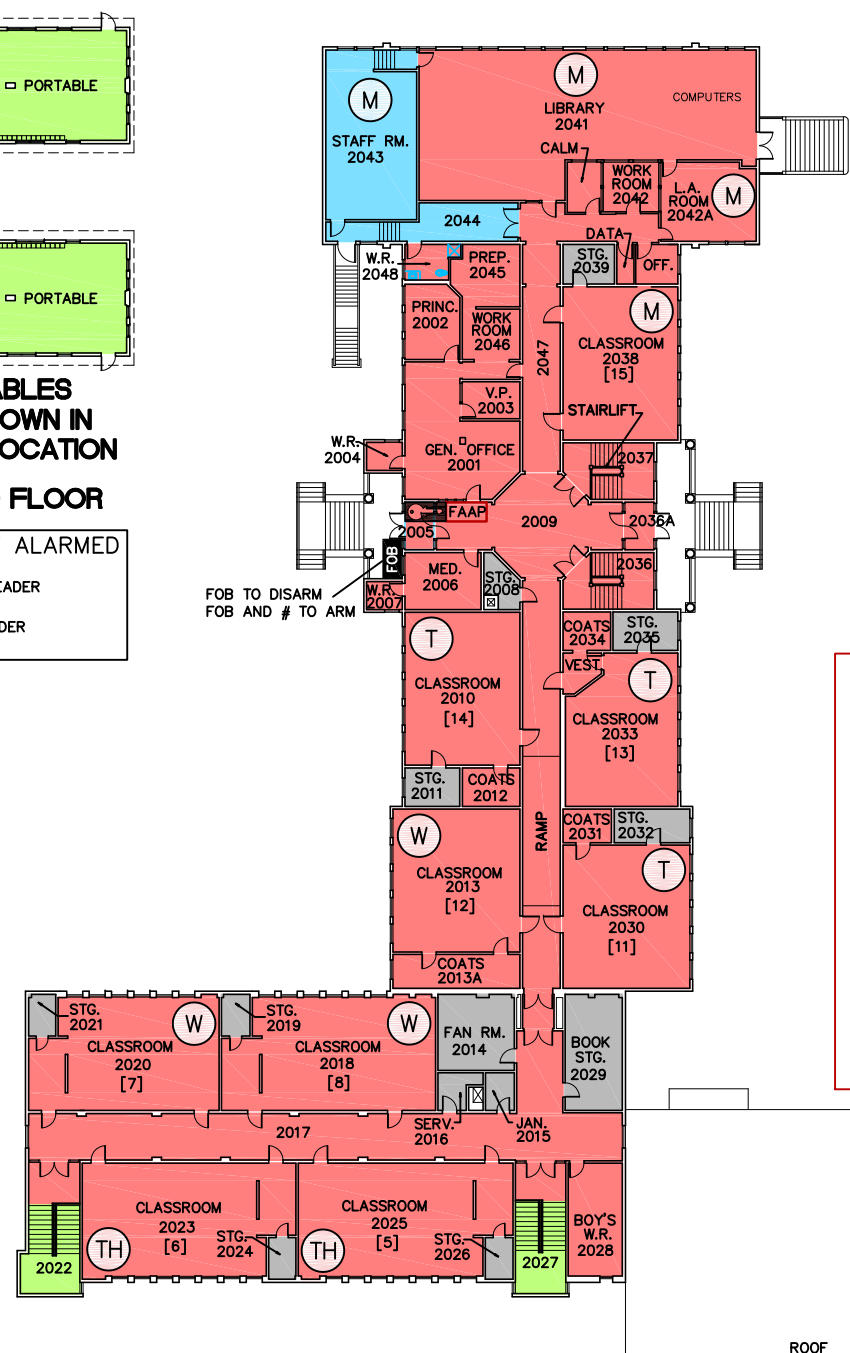

**PORTABLES
NOT SHOWN IN
EXACT LOCATION
GROUND FLOOR**

SEPARATELY ARMED
TO DISARM
1. FOB OUTSIDE READER
TO ARM
1. FOB INSIDE READER
2. PRESS #

GROUND FLOOR PLAN

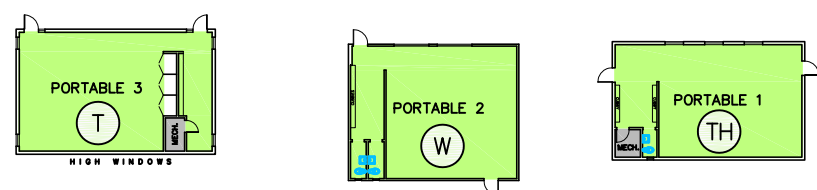

Web/App : www.Safetyline.ca
 Email Login : security+0020@sd61.bc.ca
 Password : Security+0020
 Phone : 1-866-913-3337 User ID : 0020
 Company : 116 Password : 0020

**DESKTOP CLEANING
SCHEDULE**

- K EVERY LUNCH
- M MONDAY
- T TUESDAY
- W WEDNESDAY
- TH THURSDAY
- F FRIDAY

| Run Name | Area(ft ²) | Shift Info | Split Info |
|----------|------------------------|-------------------------|---------------|
| C2 | 13,229 | 5:00am - 1:30 8.0 hours | |
| Cl-a | 25,954 | 3:30 - 12:00 8.0 hours | |
| Cl-b | 5,842 | 8:00 - 12:00 3.5 hour | From Macaulay |
| n/a | 5,100 | Not cleaned daily. | |

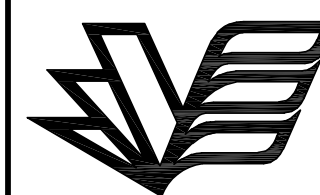

Greater
VICTORIA
School District

ESQUIMALT
SECONDARY
CUSTODIAL
RUNS

847 Colville Rd.
Victoria, B.C.
V9A 4N9

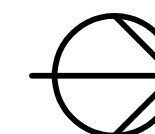

© copyright reserved
This drawing is the property of School
District #61 (Greater Victoria) and may not
be reproduced without their written consent.

| Issue no. | date | rev. | description | by | ckd by |
|-----------|------|------|-------------|----|--------|
| | | | | | |
| | | | | | |
| | | | | | |
| | | | | | |
| | | | | | |
| | | | | | |
| | | | | | |
| | | | | | |
| | | | | | |

| | |
|--------------|---------------|
| Date : | Mar, 2024 |
| Scale : | 1" = 40'-0" |
| Drawn By : | JFG |
| Facility No. | 61048 |
| Bldg Area | 125,793 sq.ft |
| SR No. | n/a |
| Drawing No. | 1 of 2 |

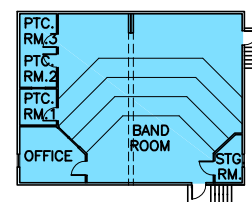

BAND ANNEX (PORTABLE 55)

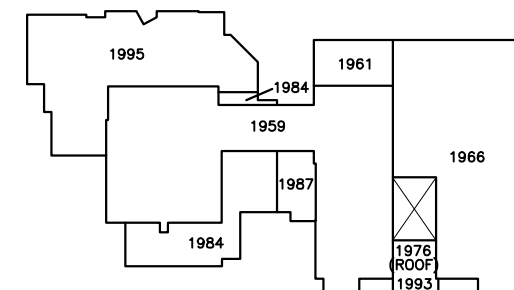

KEY PLAN
N.T.S.

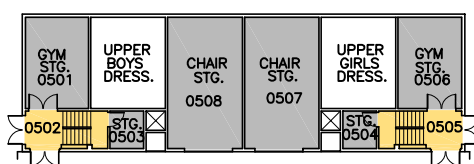
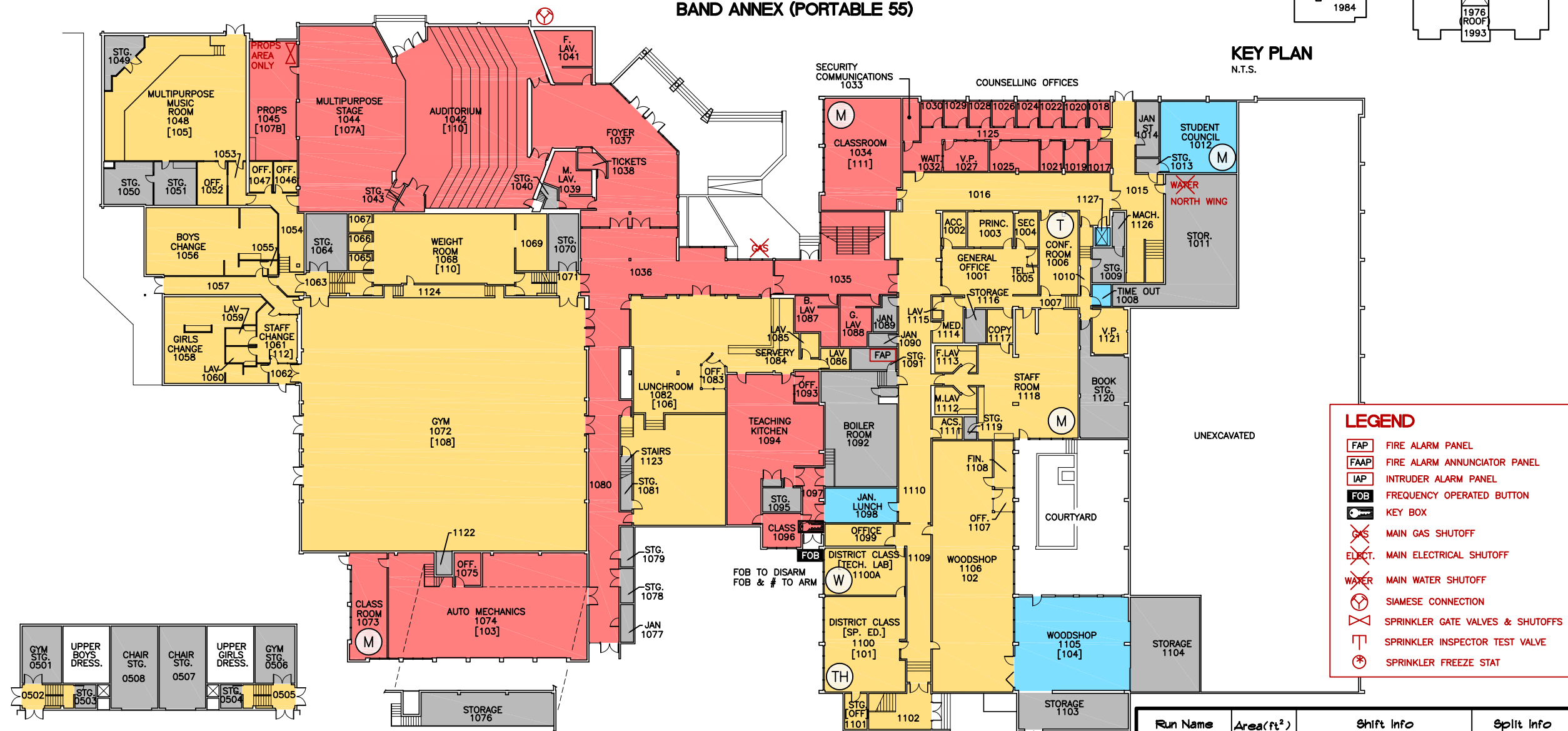

CHAIR STOR. LEVEL

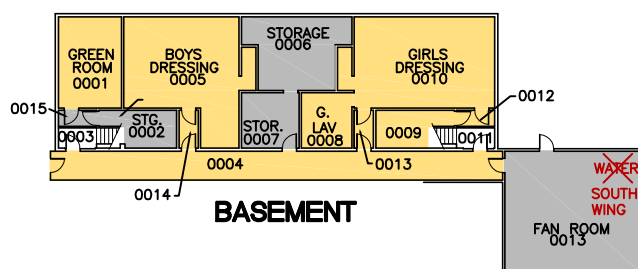

BASEMENT

MAIN FLOOR PLAN

www.safetyline.ca/login
1-866-913-3337
Company : 116
User ID : 0048
Password : 4848

DESKTOP CLEANING SCHEDULE

- (M) MONDAY
- (T) TUESDAY
- (W) WEDNESDAY
- (TH) THURSDAY
- (F) FRIDAY

| Run Name | Area(ft ²) | Shift Info | Split Info |
|----------|------------------------|------------------------|--------------|
| C2 | 8,054 | 6:00 - 2:30 8.0 hours | |
| Cl-a | 25,711 | 3:30 - 12:00 8.0 hours | |
| Cl-b | 20,381 | 3:30 - 10:00 6.0 hours | To Shoreline |
| Cl-c | 25,983 | 3:30 - 12:00 8.0 hours | |
| Cl-d | 31,505 | 3:30 - 12:00 8.0 hours | |
| n/a | 14,099 | Not cleaned daily. | |

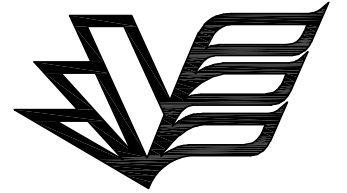

Greater
VICTORIA
School District

**ESQUIMALT
SECONDARY
CUSTODIAL
RUNS**

847 Colville Rd.
Victoria, B.C.
V9A 4N9

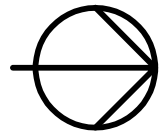

© copyright reserved
This drawing is the property of School
District #61 (Greater Victoria) and may not
be reproduced without their written consent.

| Issue no. | date | rev. | description | by | ckd by |
|-------------------------|------|------|-------------|----|--------|
| | | | | | |
| Date : Mar, 2024 | | | | | |
| Scale : 1" = 40'-0" | | | | | |
| Drawn By : JFG | | | | | |
| Facility No. 61048 | | | | | |
| Bldg Area 125,793 sq.ft | | | | | |
| SR No. n/a | | | | | |
| Drawing No. 2 of 2 | | | | | |

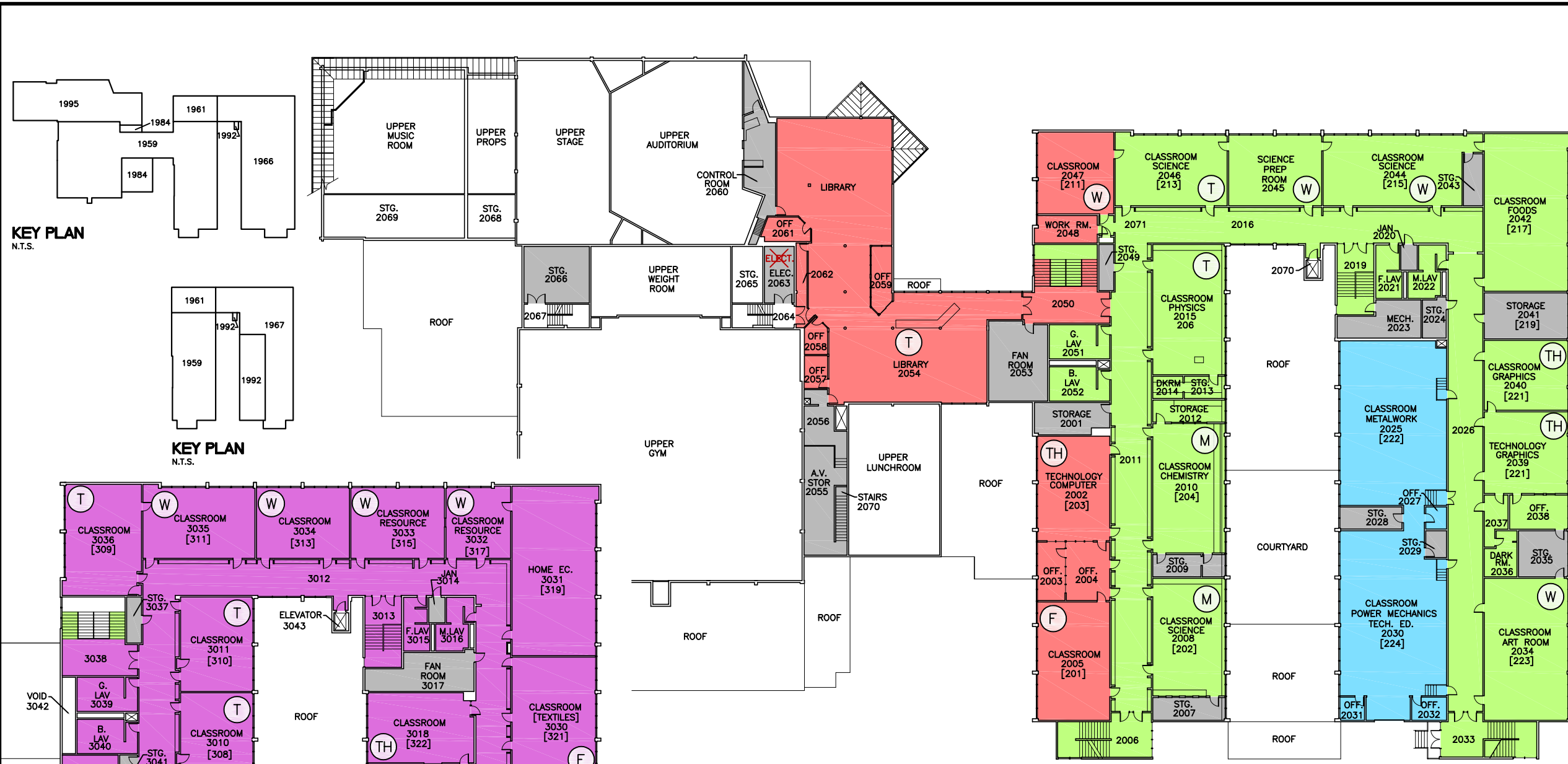

KEY PLAN
N.T.S.

KEY PLAN
N.T.S.

SECOND FLOOR PLAN

THIRD FLOOR PLAN

- LEGEND**
- FIRE ALARM PANEL
 - FIRE ALARM ANNUCIATOR PANEL
 - INTRUDER ALARM PANEL
 - FREQUENCY OPERATED BUTTON
 - KEY BOX
 - MAIN GAS SHUTOFF
 - MAIN ELECTRICAL SHUTOFF
 - MAIN WATER SHUTOFF
 - SIAMESE CONNECTION
 - SPRINKLER GATE VALVES & SHUTOFFS
 - SPRINKLER INSPECTOR TEST VALVE
 - SPRINKLER FREEZE STAT

DESKTOP CLEANING SCHEDULE

- (M) MONDAY
- (T) TUESDAY
- (W) WEDNESDAY
- (TH) THURSDAY
- (F) FRIDAY

www.safetyline.ca/login
1-866-913-3337
Company : 116
User ID : 0048
Password : 4848

| Run Name | Area(ft ²) | Shift Info | Split Info |
|----------|------------------------|------------------------|--------------|
| C2 | 8,054 | 6:00 - 2:30 8.0 hours | |
| Cl-a | 25,711 | 3:30 - 12:00 8.0 hours | |
| Cl-b | 20,381 | 3:30 - 10:00 6.0 hours | To Shoreline |
| Cl-c | 25,983 | 3:30 - 12:00 8.0 hours | |
| Cl-d | 31,505 | 3:30 - 12:00 8.0 hours | |
| n/a | 14,099 | Not cleaned daily. | |