

## CUPE 382 Internal Vacancy

### Posting Bulletin 26-01

–January 20, 2026–

Listed below is a summary of the vacancies that are currently posted at Human Resources. Only the unique details for each posting are listed below.

Individuals wishing to apply for any of the competitions are urged to view the Qualifications and Job Descriptions for each position at your worksite or HRS. Applications from the present CUPE 382 staff will be received in Human Resources (**fax: 250-475-4113**) up to 4:00 p.m. on January 27, 2026, to fill these vacancies. Individuals can apply through eServices via the GVSD Staff Portal - <https://www.sd61.bc.ca/staff-support-portal/> An Internal [Application form](#) is also available in pdf format and can be sent to Human Resources.

(In order to view the on-line application form you must have [Adobe Acrobat Reader](#) installed.  
Acrobat Reader is available free of charge.

No.	Position	Location/Term	Hours / Week	Pay Grade	Close Date	Job Specific Details
26-01T	<b>Seasonal Groundskeepers</b>  (6 positions)	<b>Facilities - Transportation</b>  <b>Term:</b> Mar. 2, 26 – Aug 28, 26	40	8	January 27, 2026	Valid Class 5 British Columbia Driver's License; Demonstrated knowledge of grounds and landscaping maintenance practices and procedures; Knowledge of job related safety regulations and techniques as outlined in WCB's Industrial Health and Safety Regulations and keeps in mind safety of others, including school children; Digital technology: including email, online databases and facilities management software used by School District #61; Maintain a cooperative working relationship with other workers, supplies, administrators, supervisors, teaching staff, students and the public; The ability to handle machinery and equipment up to 20kg and carry out basic service and maintenance of grounds related equipment in accordance with the Occupational Health and Safety Regulations; Ability to work in adverse weather conditions.
26-02C	<b>Custodian I Afternoon Shift</b>	<b>Burnside</b>  3:30 pm – 10:00 pm	30	6	January 27, 2026	Physically able to perform all duties included in the Job Characteristics; Able to climb and work from 3 metre ladders; Past experience in the custodial field desirable; Maintains a cooperative working relationship with other workers, supervisory and teaching staff, students and public. <b>Additional Duties required on a periodic basis as no C2 assigned to Burnside site:</b> Check and empty the outside garbage receptacles adjacent to the school; Attend the JOHS meeting as the CUPE 382 representative if the meeting time can be incorporated into your regular schedule and does not impede your job; Take applicable actions arising from JOHS meetings, as distributed in the meeting minutes; Request that your foreperson submit any Work Orders that need to be completed; Fill out and submit supplies order forms via fax/email.
26-03C	<b>Custodian I Afternoon Shift</b>	<b>Sundance</b>  3:30 pm – 8:30 pm  <b>Sir James</b>	22.5 / 15	6	January 27, 2026	Physically able to perform all duties included in the Job Characteristics; Able to climb and work from 3 metre ladders; Past experience in the custodial field desirable; Maintains a cooperative working relationship with other workers,

		8:30 pm – 11:30 pm				<p>supervisory and teaching staff, students and public.</p> <p><b>Additional Duties required on a periodic basis as no C2 assigned to Burnside site:</b> Check and empty the outside garbage receptacles adjacent to the school; Attend the JOHS meeting as the CUPE 382 representative if the meeting time can be incorporated into your regular schedule and does not impede your job; Take applicable actions arising from JOHS meetings, as distributed in the meeting minutes; Request that your foreperson submit any Work Orders that need to be completed; Fill out and submit supplies order forms via fax/email.</p>
26-04C	<b>Custodian I Afternoon Shift</b>	<p><b>Monterey</b></p> <p>3:30 pm – 12:00 am</p>	40	6	January 27, 2026	Physically able to perform all duties included in the Job Characteristics; Able to climb and work from 3 metre ladders; Past experience in the custodial field desirable; Maintains a cooperative working relationship with other workers, supervisory and teaching staff, students and public.
26-05C	<p><b>Custodian I Afternoon Shift - C1B</b></p> <p>Please refer to the attached floor map for the cleaning area</p>	<p><b>Vic High</b></p> <p>3:30 pm – 12:00 am</p>	40	6	January 27, 2026	Physically able to perform all duties included in the Job Characteristics; Able to climb and work from 3 metre ladders; Past experience in the custodial field desirable; Maintains a cooperative working relationship with other workers, supervisory and teaching staff, students and public.
26-06C	<p><b>Custodian I Afternoon Shift - C1D</b></p> <p>Please refer to the attached floor map for the cleaning area</p>	<p><b>Vic High</b></p> <p>3:30 pm – 12:00 am</p>	40	6	January 27, 2026	Physically able to perform all duties included in the Job Characteristics; Able to climb and work from 3 metre ladders; Past experience in the custodial field desirable; Maintains a cooperative working relationship with other workers, supervisory and teaching staff, students and public.

**NOTE: Current proof of qualifications must be in your employee file at Human Resource Services by the closing date of the competition for which you are applying.**

**IF YOU WOULD LIKE MORE INFORMATION REGARDING THESE VACANCIES, PLEASE CONTACT PRINCIPAL/SUPERVISOR**

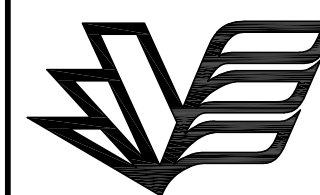

Greater  
**VICTORIA**  
School District

VICTORIA  
HIGH SCHOOL  
CUSTODIAL  
RUNS

1260 Grant St.  
Victoria, B.C.  
V8T 1C2

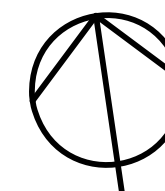

© copyright reserved  
This drawing is the property of School District #61 (Greater Victoria) and may not be reproduced without their written consent.

Issue no.	date	rev.	description	by	ckd by

Date : Nov, 2025

Scale : 1" = 40'-0"

Drawn By : JFG

Facility No. 6108

Bldg. Area 167,144sqft

Capital No.

Drawing No. 1 of 4

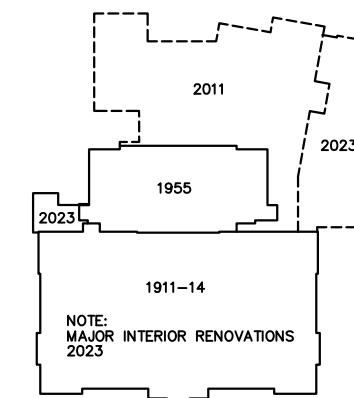

KEY PLAN N.T.S.

**LEGEND**

- FAP FIRE ALARM PANEL
- FAAP FIRE ALARM ANNUCIATOR PANEL
- IAP INTRUDER ALARM PANEL
- FOB FREQUENCY OPERATED BUTTON
- KB KEY BOX
- ✕ MAIN GAS SHUTOFF
- ELECT. MAIN ELECTRICAL SHUTOFF
- ✕ MAIN WATER SHUTOFF
- ⊗ SIAMESE CONNECTION
- ⊗ SPRINKLER GATE VALVES & SHUTOFFS
- ⊕ SPRINKLER INSPECTOR TEST VALVE
- ⊕ SPRINKLER FREEZE STAT

**DESKTOP CLEANING SCHEDULE**

- M MONDAY
- T TUESDAY
- W WEDNESDAY
- TH THURSDAY
- F FRIDAY

Web/App : [www.Safetyline.ca](http://www.Safetyline.ca)  
 Email Login : security+0018@sd61.bc.ca  
 Password : Security+0018  
 Phone : 1-866-913-3337 User ID : 0018  
 Company : 116 Password : 0018

Run Name	Area(ft <sup>2</sup> )	Shift Info	Split Info
C2	11,629	6:00 - 2:30 8.0 hours	
Cl-a	43,081	3:30 - 12:00 8.0 hours	
Cl-b	35,475	3:30 - 12:00 8.0 hours	
Cl-c	25,970	3:30 - 12:00 8.0 hours	
Cl-d	34,775	3:30 - 12:00 8.0 hours	
n/a	16,814	Not cleaned daily.	

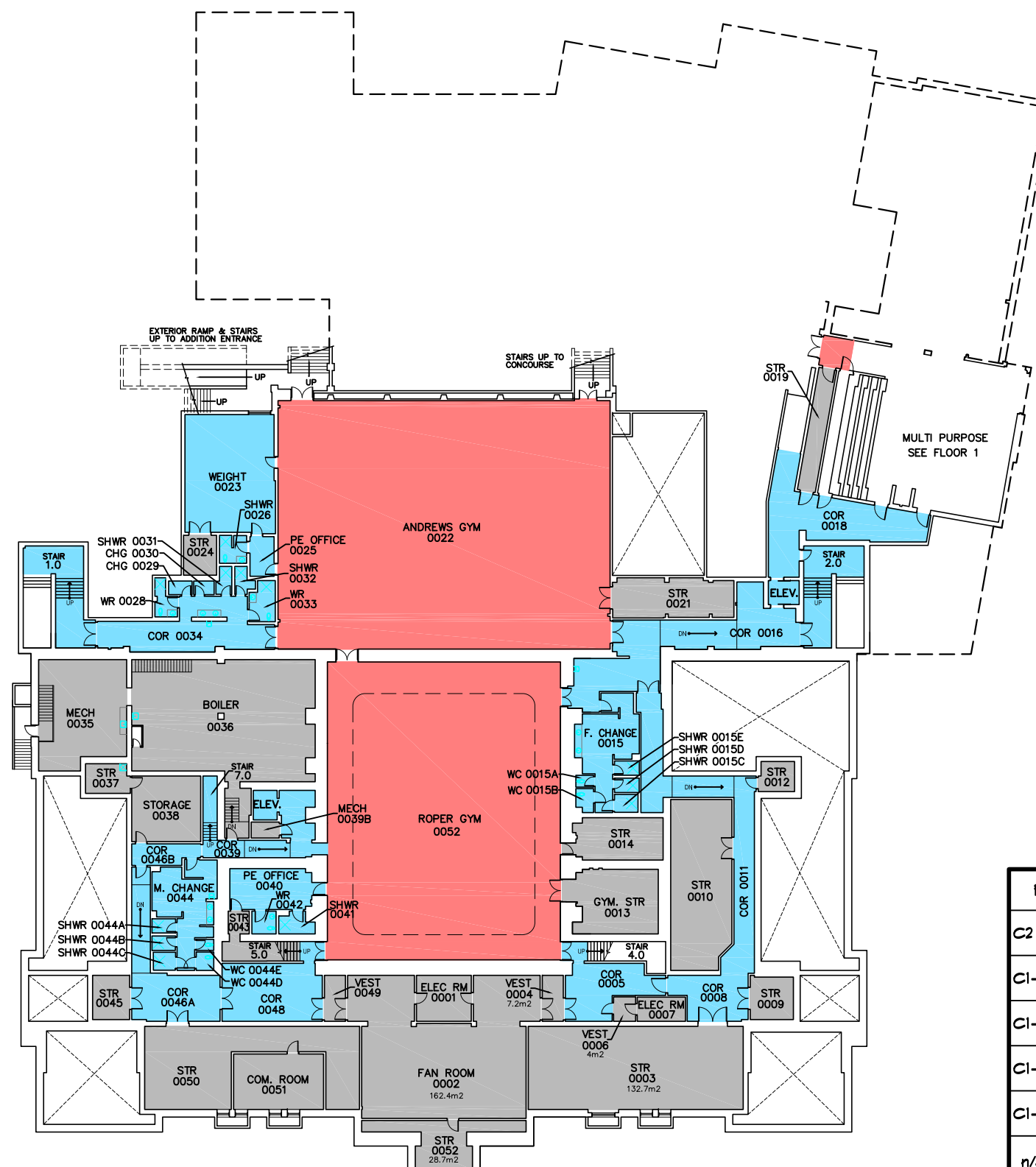

**BASEMENT PLAN**



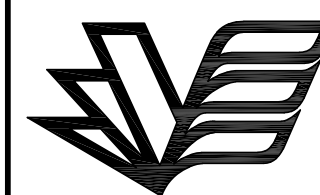

Greater  
**VICTORIA**  
School District

VICTORIA  
HIGH SCHOOL  
CUSTODIAL  
RUNS

1260 Grant St.  
Victoria, B.C.  
V8T 1C2

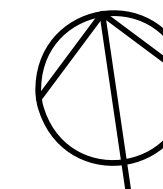

© copyright reserved  
This drawing is the property of School  
District #61 (Greater Victoria) and may not  
be reproduced without their written consent.

Issue no.	date	rev.	description	by	ckd by

Date : Nov, 2025

Scale : 1" = 40'-0"

Drawn By : JFG

Facility No. 6108

Bldg. Area 167,744sqft

Capital No.

Drawing No. 3 of 4



SECOND FLOOR

SWITCH TO TURN OFF  
AUTO DOOR PADELS

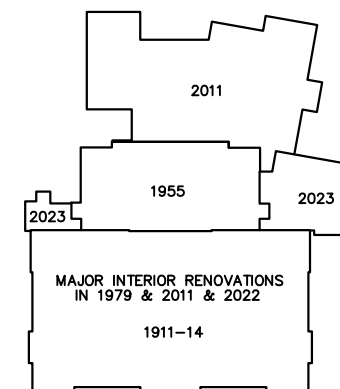

KEY PLAN n.t.s.

**LEGEND**

- FAP FIRE ALARM PANEL
- FAAP FIRE ALARM ANNUCIATOR PANEL
- IAP INTRUDER ALARM PANEL
- FOB FREQUENCY OPERATED BUTTON
- KB KEY BOX
- X MAIN GAS SHUTOFF
- ELECT. MAIN ELECTRICAL SHUTOFF
- WATER MAIN WATER SHUTOFF
- SC SIAMESE CONNECTION
- SGV SPRINKLER GATE VALVES & SHUTOFFS
- T SPRINKLER INSPECTOR TEST VALVE
- FS SPRINKLER FREEZE STAT

**DESKTOP CLEANING SCHEDULE**

- M MONDAY
- T TUESDAY
- W WEDNESDAY
- TH THURSDAY
- F FRIDAY

Web/App : [www.Safetyline.ca](http://www.Safetyline.ca)  
 Email Login : security+0018@sd61.bc.ca  
 Password : Security+0018  
 Phone : 1-866-913-3337 User ID : 0018  
 Company : 116 Password : 0018

Run Name	Area(ft <sup>2</sup> )	Shift Info	Split Info
C2	11,629	6:00 - 2:30 8.0 hours	
Cl-a	43,081	3:30 - 12:00 8.0 hours	
Cl-b	35,475	3:30 - 12:00 8.0 hours	
Cl-c	25,970	3:30 - 12:00 8.0 hours	
Cl-d	34,775	3:30 - 12:00 8.0 hours	
n/a	16,814	Not cleaned daily.	

**LEGEND**

- FAP FIRE ALARM PANEL
- FAAP FIRE ALARM ANNUCIATOR PANEL
- IAP INTRUDER ALARM PANEL
- FOB FREQUENCY OPERATED BUTTON
- KB KEY BOX
- X MAIN GAS SHUTOFF
- ELECT. MAIN ELECTRICAL SHUTOFF
- WATER MAIN WATER SHUTOFF
- SC SIAMESE CONNECTION
- S SPRINKLER GATE VALVES & SHUTOFFS
- IT SPRINKLER INSPECTOR TEST VALVE
- FS SPRINKLER FREEZE STAT

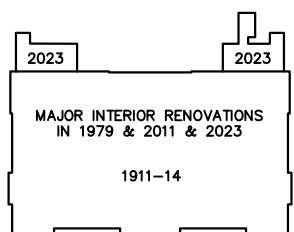

KEY PLAN N.T.S.

**DESKTOP CLEANING SCHEDULE**

- (M) MONDAY
- (T) TUESDAY
- (W) WEDNESDAY
- (TH) THURSDAY
- (F) FRIDAY

Run Name	Area(ft <sup>2</sup> )	Shift Info	Split Info
C2	11,629	6:00 - 2:30 8.0 hours	
Cl-a	43,081	3:30 - 12:00 8.0 hours	
Cl-b	35,475	3:30 - 12:00 8.0 hours	
Cl-c	25,910	3:30 - 12:00 8.0 hours	
Cl-d	34,775	3:30 - 12:00 8.0 hours	
n/a	16,814	Not cleaned daily.	

Web/App : [www.Safetyline.ca](http://www.Safetyline.ca)  
 Email Login : security+0018@sd61.bc.ca  
 Password : Security+0018  
 Phone : 1-866-913-3337 User ID : 0018  
 Company : 116 Password : 0018

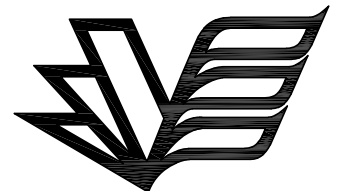

Greater  
**VICTORIA**  
School District

VICTORIA  
HIGH SCHOOL  
CUSTODIAL  
RUNS

1260 Grant St.  
Victoria, B.C.  
V8T 1C2

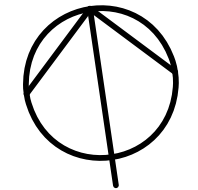

© copyright reserved  
This drawing is the property of School District #61 (Greater Victoria) and may not be reproduced without their written consent.

Issue No.	Date	Rev.	Description	By	CKD By

Date : Nov, 2025

Scale : 1" = 40'-0"

Drawn By : JPG

Facility No. 61018

Bldg. Area 167,744sqft

Capital No.

Drawing No. 4 of 4

