



Sundance-Bank Elementary School Engagement Report

November 2024

Table of Contents

Introduction.....	3
Purpose.....	4
Open House Event Summary	4
Communications & Advertising	4
Open House Information Boards	6
Summary of Feedback Boards.....	6
4.4 Expansion Options.....	6
5.0 Neighbourhood Learning Centre	7
6.0 Any other Feedback?	7
Online Survey	7
Conclusion.....	9
Appendices	10
Appendix A: Open House Invitation/Flyer	A1
Appendix B: All Boards	B1
Appendix C: Boards with Transcribed Sticky Note Comments	C1
Appendix D: Online Survey	D1
Appendix E: Survey Results.....	E1



Introduction

The Greater Victoria School District (GVSD), in collaboration with Iredale Architects and MAKE Projects Limited, has developed a Project Definition Report (PDR) and determined that Sundance-Bank Elementary School is in need of a seismic upgrade and expansion based on:

- **Enrolment Increase:** In 2024-2025, the school is serving 86 students in Kindergarten to Grade 3. To ensure capacity for future students, further grades will be added until the 2026-2027 school year when the school will serve Kindergarten to Grade 5. Enrolment projections have defined the need to increase capacity to 240 students.
- **Facilities Conditions:** The latest Facility Condition Report stated a Facility Condition Index (FCI) for the Sundance building of 74% (a FCI rating of 30% places the facility in critical condition) and a FCI of over 100% for the Bank Street School building.
- **Seismic Requirements:** Both buildings are severely outdated with respect to current seismic codes and educational needs, requiring significant investment to be usable. The seismic classification of both buildings in the event of an earthquake is High 1 (H1), or in other words, has the highest risk of widespread structural failure and a Probability of P1 with expectations of total damage, highest life safety consequences, and total collapse.

The PDR has revealed three potential viable options to address the above concerns:

Options	Option 1: Involves expanding Sundance-Bank Elementary School onto the adjacent Garry Oak Field.	Option 2: Involves demolishing the existing Bank Street School and expanding Sundance-Bank Elementary School by way of modular building units on the property.	Option 3: Involves demolishing the existing Bank Street School and expanding Sundance-Bank Elementary School on the Bank Street School site through traditional construction means.
Considerations	<ul style="list-style-type: none"> • Existing Bank Street School remains with 13m high permanent safety barrier • Impact on Garry Oak trees • Less natural play space • Smaller play field 	<ul style="list-style-type: none"> • Demolition of Bank Street School • Some impact to Garry Oak trees • Covered parking below the building • Natural play area retained • Modular units built quicker • Potential future maintenance costs 	<ul style="list-style-type: none"> • Demolition of Bank Street School • Least impact to Garry Oak trees • More natural play area available
	<ul style="list-style-type: none"> • Expanded learning space to 10 classrooms (240 capacity) • Neighbourhood Learning Centre (NLC) included • Childcare on site • Demolition of the existing Sundance building 		

Purpose

The purpose of this document is to summarize meaningful engagement with stakeholders including Rightsholders, present and future students, teachers, families, feeder school families and students, neighbours, and various other community groups and individuals. This document aims to capture public feedback gathered through an open house event and online survey which:

- 1) Informed the public of three seismic upgrade and expansion options for the Sundance-Bank site and sought feedback on which of the three options was the most preferred.
- 2) Informed the public of a planned NLC at the site and gained feedback on preferred amenities.

Open House Event Summary

Public Open House #1

Date: Wednesday, August 7, 2024
Location: Sundance-Bank Elementary School Gymnasium
Format: In-person drop-in gallery style display of boards and informal Q&A
Attendees: ~50 community members including parents/caregivers of current and future students, Sundance-Bank neighbours, Oak Bay neighbours
 2 Board of Education Trustees
 5 GVSD representatives
 2 Iredale Architects representatives
 1 MAKE Projects Limited representative

Communications & Advertising

Invitations to the open house (including QR code and link to the online survey) were sent to the following groups:

	Group	Medium	Date
1	City of Victoria Counsellors	Email with PDF Invitation	July 30, 2024
2	Trustees	Email with PDF Invitation	July 30, 2024
3	Four Houses	Email with PDF Invitation	July 31, 2024
4	Sundance-Bank Staff and Administration	Email with PDF Invitation	July 31, 2024
5	Sundance-Bank Families	School Messenger	July 31, 2024
6	South Jubilee Neighbourhood Association	Email with PDF Invitation	July 31, 2024

After invitations were sent out, a media advisory was distributed to promote both the open house and the survey which was to go live the same day, August 7, 2024. The media advisory was sent to local radio stations, TV stations, and newspapers (CFAX, CTV, CHEK, Times Colonist, Black Press, etc.) and [earned coverage](#). The media advisory was also posted to the School District's website and advertised on the home page of the website using the banner slide function.

The open house and survey were advertised through print ads in the Oak Bay News newspaper and on the School District's social media platforms (Instagram, Facebook, X).

Flyers promoting the open house and the feedback survey were distributed to 200 houses in the Sundance-Bank neighbourhood on July 31, 2024. Posters were also placed on existing signage at the school and neighbourhood hubs such as Redfern Park. The flyer/poster/invitation is included as **Appendix A** within this report.



Print ad for Oak Bay News



Poster at Red Fern Park

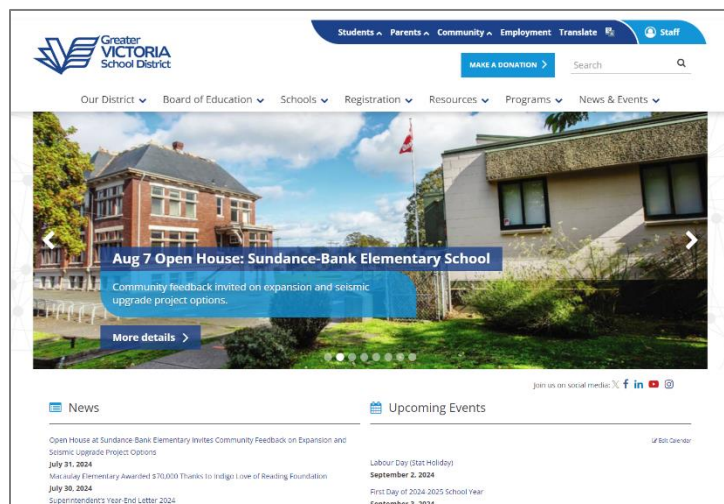

Website banner



Poster at Bank Street School site

Open House Information Boards

There were ten boards (**Appendix B** with **Appendix C** including transcribed comments) that were presented to the public in a gallery-style format:

- A welcome board with a Territorial Acknowledgement
- A section outlining the project rationale for both school sites (2 boards)
- A board to showcase the project timeline and define the scope of feedback
- A section outlining the proposed project options with considerations and proposed site plans (3 informational boards, 1 board seeking input)
- A board explaining Neighbourhood Learning Centres (1 board seeking feedback on amenities)
- A board seeking input on any additional feedback

Participants were encouraged to provide responses to the prompting questions using sticky notes, by adding stickers to indicate their preferences, or by filling out the online survey. Paper comment cards were available for attendees, should that be a more accessible option than moving about the space or accessing the online survey.

Members of Iredale Architects, Make Projects and the School District were on hand to answer questions and listen to comments. All feedback was recorded and incorporated into this document.

Summary of Feedback Boards

4.4 Expansion Options

Question: *Of the three proposed expansion options, which do you prefer for the future of Sundance-Bank Elementary School? Why?*

The majority of respondents supported Option 3 with many noting that this option presents a long-term focus with less impact to natural areas. Option 1 and 2 had lower levels of support. Of those that preferred Option 1, many commented on saving Bank Street School due to its history and heritage. Many of those that supported Option 2 commented on a preference for underground parking and faster construction.

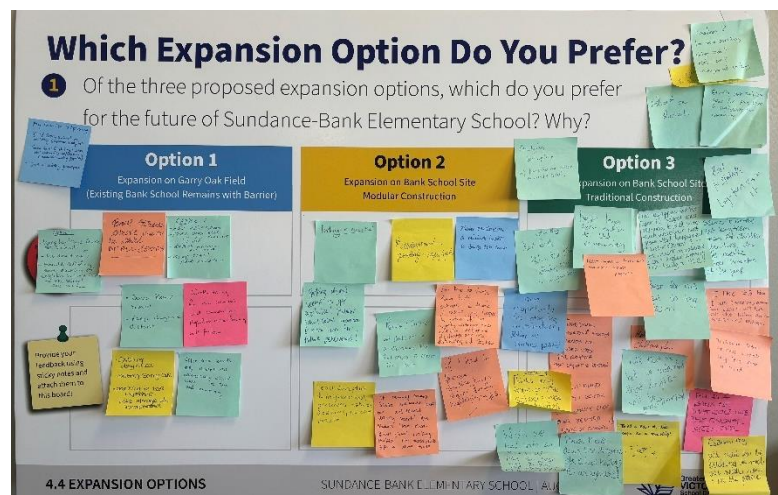

5.0 Neighbourhood Learning Centre

Question: *Place a sticker to support your three preferred features for a new Neighbourhood Learning Centre.*

The majority of respondents indicated their preferences for multi-purpose space, community kitchen, before-school and after-school care, and enhanced indoor gymnasium space. No respondents indicated a preference for community sports equipment storage.

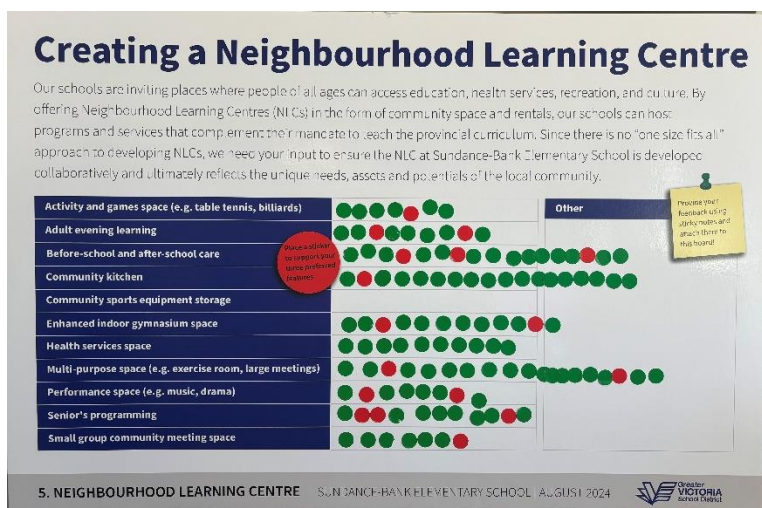

6.0 Any other Feedback?

Question: *Should we consider anything else as this project continues?*

Many comments reiterated feedback received from the 4.4 Expansion Options board. New comments or concerns included:

- Interest to know more about funding/cost of each option and project timelines
- Interest in building a new school that resembles the Bank Street School
- Concern for Leighton intersection during construction
- Concern for environmental impacts of each option
- Curiosity for where an outdoor playground would go
- Curiosity for who owns the Bank Street School building

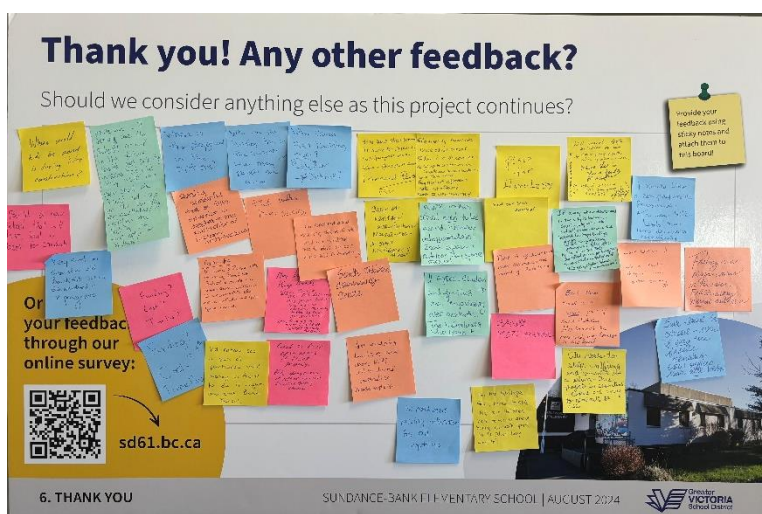

Online Survey

The school district also produced a public survey. The 10-question survey was posted on the website and was open from August 7 to August 21 (and extended to August 31) after its launch at the August 7 Open House. The survey was promoted through the same avenues as the Open House, using a QR code to direct community members to the digital survey. There was a total of 487 responses.

Respondents included Rightsholders, neighbours, parents, community members, and staff. A copy of the survey (**Appendix D**) and survey response summaries (**Appendix E**) are included in this report.

The survey focused on the same two questions as the open house:

1) Of the three proposed expansion options, which do you prefer for the future of Sundance-Bank Elementary School?

Option 3 stood out as the most preferred option, with 59% of respondents agreeing with this option compared to 32% for Option 1 and 23% for Option 2.

Options	Option 1: Involves expanding Sundance-Bank Elementary School onto the adjacent Garry Oak Field.	Option 2: Involves demolishing the existing Bank Street School and expanding Sundance-Bank Elementary School by way of modular building units on the property.	Option 3: Involves demolishing the existing Bank Street School and expanding Sundance-Bank Elementary School on the Bank Street School site through traditional construction means.
Results	<ul style="list-style-type: none"> • 32% for • 68% against 	<ul style="list-style-type: none"> • 23% for • 77% against 	<ul style="list-style-type: none"> • 59% for • 41% against

Themes summarized from long-answer questions about hopes and concerns:

- Community understands the need for site upgrades from a safety perspective
- The small-scale community-feel of the school is important with some respondents mentioning desire to keep the façade of the original school (with some direct references to Vic High) or to at least ensure it visually fits the character of the neighbourhood (no desire for “plastic panels,” “cheap materials,” or “artistic statements”)
- Accessibility within and around the school should be prioritized (especially for parking)
- The growing neighbourhood needs a larger school (both in the sense of number of classroom and spanning Kindergarten to Grade 5) with more community space
- Desire to preserve outdoor green spaces for the school and community use (support for maintaining green spaces and Garry Oak trees)
- Concerns about construction interfering with surrounding traffic flow and potential for road closures and limited street access in the neighbourhood
- Concerns about limited availability of street parking, as parking is already an issue
- Some respondents inquired about where students will go while the construction takes place and how their drop-off/pick-up routines may change
- Concerns about project timelines and eagerness to begin the project (no matter the preferred option)
- Mixed comments on either keeping the heritage building and knocking it down to rebuild

- Concerns about the barrier wall being an eye sore if the Bank Street School building were to be maintained
- Some references to moving past heritage/colonial preservation and looking forward to developing inclusive spaces that commit to reconciliation and Indigenous-use spaces

2) What amenities would you be interested in seeing included in the Neighbourhood Learning Centre located within the upgraded Sundance-Bank Elementary School? Select your top three priorities.

“Before and after school care” (337 votes) had the most support by far with “multi-purpose space” (173 votes), “performance space” (143 votes), and “adult evening learning” (139 votes) also receiving support.

Additional themes noted from long-answer question about the NLC:

- Many mentions of respondents opting for “whatever is best for student use”
- Some respondents questioning funding and budget within their answers (potential for more education about where an NLC receives funding from)
- Interest for a community library
- Interest for more outdoor play space (without interfering with Garry Oak trees)
- Garden space was also a popular additional amenity (some referring to a vegetable garden and some referring to an Indigenous garden)
- Some respondents noting that funding would be better spent on upgrading existing community spaces (such as Oak Bay Recreation Centre) rather than using funding to replicate such spaces as additions to the school
- Some respondents expressed interest in using NLC funding for the school itself (i.e. learning and classroom spaces) to benefit students

Conclusion

Based on feedback collected during the open house held on August 7, 2024 and subsequent online survey, the Greater Victoria School District, architect team, and MAKE Projects will consider Option 3 as a potential way forward to upgrade the Sundance-Bank site. The Greater Victoria School District will consider all feedback collected and aims to inform the community about future updates including potential future additional engagement sessions.

Appendices

Appendix A	Open House Invitation/Flyer
Appendix B	All Boards
Appendix C	Boards with Transcribed Sticky Note Comments
Appendix D	Online Survey
Appendix E	Survey Results

Appendix A: Open House Invitation/Flyer



You're Invited!

OPEN HOUSE: August 7, 2024 at 4:00pm

Help shape the future of Sundance-Bank Elementary School

As a member of the Sundance-Bank learning community, we'd like to invite you to an open house on Wednesday, August 7, 2024 from 4:00pm to 7:00pm. Drop in to the gymnasium at Sundance-Bank Elementary School to voice your input and ideas for the future.

Your comments will help inform which expansion option will be considered to address current challenges that the school is facing such as enrolment increases, facilities conditions, and seismic safety requirements. We would also like your help to prioritize features within the school's new Neighbourhood Learning Centre.

We look forward to creating collaborative spaces together.

Can't make the open house? Take the survey!



Survey opens on August 7: visit www.sd61.bc.ca or scan the QR code to have your say!

This survey closes on Wednesday, August 21, 2024 at 4:00pm.
Email community@sd61.bc.ca if you need support.

The Greater Victoria School District wishes to recognize and acknowledge the Esquimalt and Songhees Nations, on whose traditional territories, we live, we learn, and we do our work.

www.sd61.bc.ca | community@sd61.bc.ca

Page 1/1

Appendix B: All Boards

WELCOME

SUNDANCE-BANK ELEMENTARY SCHOOL

The Greater Victoria School District wishes to recognize and acknowledge the Esquimalt and Songhees Nations, on whose traditional territories, we live, we learn, and we do our work.



1. TERRITORIAL ACKNOWLEDGMENT

SUNDANCE-BANK ELEMENTARY SCHOOL | AUGUST 2024



Sundance School Project Rationale

1 Enrolment Increase

- Projected enrolment increase of 2,300 within the District over the next 15 years.
- In 2023, Sundance served 86 students in Kindergarten to Grade 2.
- Enrolment projections defined the need to increase capacity to 240.
- Further grades will be added until the 2025/26 school year when the school will serve Kindergarten to Grade 5.



2 Facilities Condition

- The latest Facility Condition Report stated a Facility Condition Index (FCI) of 74%.
- A FCI rating of 30% places the facility in critical condition and is at risk of:
 - Not being able to meet educational requirements
 - Potential consistent issues with building envelope
 - Major building system failures
 - High user dissatisfaction
 - Deferred maintenance at unacceptable levels



3 Seismic Requirements

- The 1967 building is severely outdated with respect to current seismic code requirements and educational needs.
- In September 2023, a Seismic Project Identification Report was conducted to evaluate the performance of the facility.
- The report determined that during a seismic event, the school will experience:
 - Total damage
 - Highest life safety consequences
 - Demolition post-event outcome

2.1 BACKGROUND INFORMATION

SUNDANCE-BANK ELEMENTARY SCHOOL | AUGUST 2024



Bank School Project Rationale

1 Building Background

- Heritage Registered Building constructed in 1910.
- Currently empty and in a state of disrepair with no funding available for maintenance.
- Would require significant upgrades to be safe and functional including:
 - Building accessibility (ramps, elevators, and other accessible features)
 - Building envelope
 - Windows
 - Roof
 - Mechanical/electrical systems
 - Full interior retrofit
- Classroom sizes do not meet current day standards.



2 Facilities Condition

- The building has a predicted Facility Condition Index (FCI) of 100%.
- FCI is in a critical state due to the age and failure of current systems.
- A FCI rating of 30% places the facility in a critical condition and is at risk of:
 - Not being able to meet educational requirements
 - Potential consent issues with building envelope
 - Major building system failures
 - High user dissatisfaction
 - Deferred maintenance at unacceptable levels

3 Seismic Requirements

- The 1910 building is severely outdated with respect to current seismic codes and educational needs, requiring significant investment to be suitable.
- Seismic classification in the event of an earthquake:
 - High (3.0): highest risk of widespread structural failure
 - Probability 1 (P1): expectations of total damage, highest life safety consequences, and total collapse
- Various assessments in 2020 and 2021 indicate seismic retrofit and upgrades would cost between \$5.7 million to \$7.6 million.



2.2 BACKGROUND INFORMATION

SUNDANCE-BANK ELEMENTARY SCHOOL | AUGUST 2024



Project Timeline



Your Feedback Needed on Two Topics

- Of the three proposed expansion options, which do you prefer for the future of Sundance-Bank Elementary School?
- Knowing that the future of Sundance-Bank will include a Neighbourhood Learning Centre (NLC), how do you envision this space?

3. TIMELINE & ENGAGEMENT

SUNDANCE-BANK ELEMENTARY SCHOOL | AUGUST 2024



Option 1: Expansion on Garry Oak Field

Considerations Unique to Option 1:

- Existing Bank School remains with 13m high permanent safety barrier

- Impact on Garry Oak trees
- Less natural play space
- Smaller play field

Considerations (For All Options):

- 10 classrooms (240 capacity)
- NLC included
- Child care on site

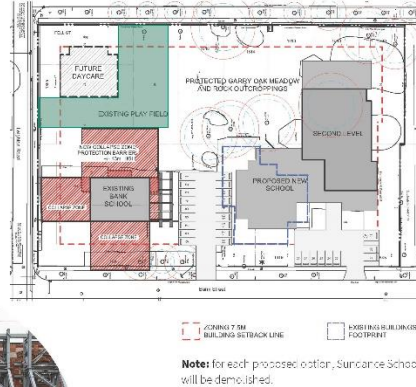

At a height of 13 metres, a permanent safety barrier is required so long as Bank School remains standing.

4.1 EXPANSION OPTIONS

SUNDANCE-BANK ELEMENTARY SCHOOL | AUGUST 2024



Option 2: Expansion on Bank School Site Modular Construction

Considerations Unique to Option 2:

- Demolition of Bank School

- Some impact to Garry Oak trees
- Covered parking below building
- Natural play area retained
- Modular units built quicker
- Potential future maintenance costs

Considerations (For All Options):

- 10 classrooms (240 capacity)
- NLC included
- Child care on site

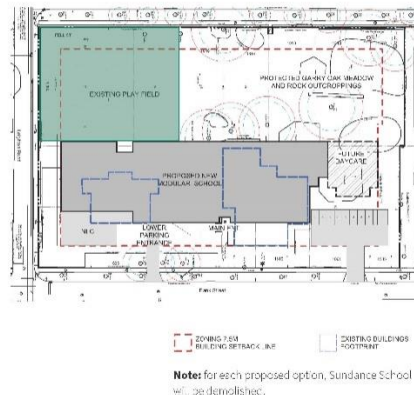

4.2 EXPANSION OPTIONS

SUNDANCE-BANK ELEMENTARY SCHOOL | AUGUST 2024



Option 3: Expansion on Bank School Site

Traditional Construction

Considerations Unique to Option 3:

•Demolition of Bank School

- Least impact to Garry Oak trees
- More natural play area available

Considerations (For All Options):

- 10 classrooms (240 capacity)
- NLC included
- Child care on site

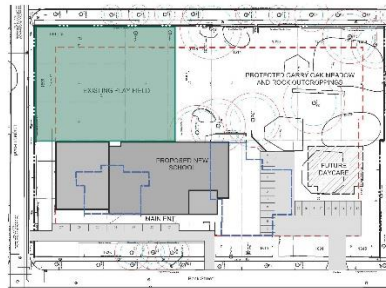

4.3 EXPANSION OPTIONS

SUNDANCE-BANK ELEMENTARY SCHOOL | AUGUST 2024



Which Expansion Option Do You Prefer?

- 1 Of the three proposed expansion options, which do you prefer for the future of Sundance-Bank Elementary School? Why?

	Option 1 Expansion on Garry Oak Field (Existing Bank School Remains with Barrier)	Option 2 Expansion on Bank School Site Modular Construction	Option 3 Expansion on Bank School Site Traditional Construction
Place a sticker to support your three preferred features			
Provide your feedback using sticky notes and attach them to this board:			

4.4 EXPANSION OPTIONS

SUNDANCE-BANK ELEMENTARY SCHOOL | AUGUST 2024



Creating a Neighbourhood Learning Centre

Our schools are inviting places where people of all ages can access education, health services, recreation, and culture. By offering Neighbourhood Learning Centres (NLCs) in the form of community space and rentals, our schools can host programs and services that complement their mandate to teach the provincial curriculum. Since there is no "one size fits all" approach to developing NLCs, we need your input to ensure the NLC at Sundance-Bank Elementary School is developed collaboratively and ultimately reflects the unique needs, assets and potentials of the local community.

Activity and games space (e.g. table tennis, billiards)		Other
Adult evening learning		
Before-school and after-school care		
Community kitchen		
Community sports equipment storage		
Enhanced indoor gymnasium space		
Health services space		
Multi-purpose space (e.g. exercise room, large meetings)		
Performance space (e.g. music, drama)		
Senior's programming		
Small group community meeting space		

Place a sticker to support your three preferred features.

Provide your feedback using sticky notes and attach them to this board.

5. NEIGHBOURHOOD LEARNING CENTRE SUNDANCE-BANK ELEMENTARY SCHOOL | AUGUST 2024



Thank you! Any other feedback?

Should we consider anything else as this project continues?

Or provide your feedback through our online survey:



sd61.bc.ca

Provide your feedback using sticky notes and attach them to this board.



6. THANK YOU

SUNDANCE-BANK ELEMENTARY SCHOOL | AUGUST 2024



Appendix C: Boards with Transcribed Sticky Note Comments

4.4 Expansion Options

Option 1 Sticky Note Comments: Expansion on Garry Oak Field (Existing Bank Street School Remains with Barrier)

- Existing play area
- Existing Garry Oaks
- Parking is less important, bike storage should be incorporated
- Save Bank School
- Keep daycare distant
- Worth saving the school and community, hopefully more funding will follow
- Add vegetation, tear down building if too expensive to use, better working building, more space for residence.
- Keep heritage bank st school. Fundraising? Should definitely leave blocking off Leighton until decision on school are made
- Option 1 sounds very interesting architecturally which would be fun and exciting
- Bank St school must be saved at all costs

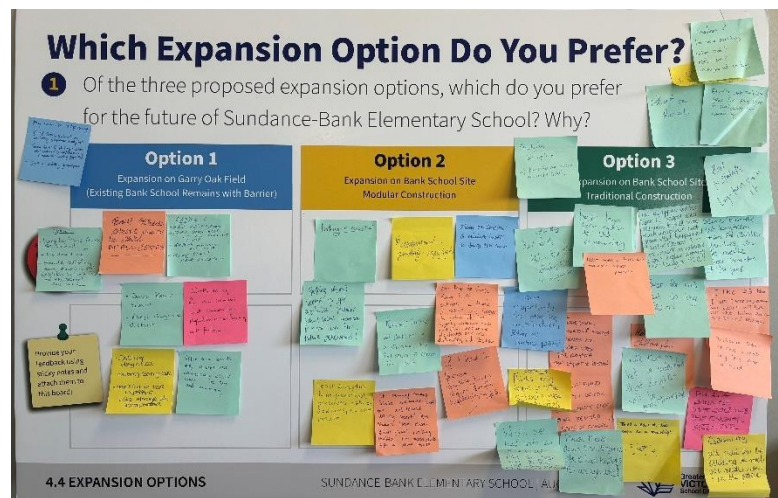

Option 2 Sticky Note Comments: Expansion on Bank Street School Site (Modular Construction)

- Parking is essential
- Faster construction and minimal impact to Garry Oak Trees
- Least disruptive to Neighbourhood, preserves natural features, quickest results
- Parking always seems to get overlooked! Modular school seems innovative and more room for future generations
- Underground parking important
- Parking and traffic on Bank St is a nightmare. This plan seems to address the best
- It actually makes more sense and would look cool and would actually benefit the students the most. Underground parking makes the most sense space wise as well
- I am fine with taking down both schools. I think it takes way longer to retrofit. I am slightly leaning towards the modular because it's faster and less disturbing but see how the traditional construction is better long term.

Option 3 Sticky Note Comments: Expansion on Bank Street School Site (Traditional Construction)

- Grudgingly best option. If funding no option, renovate both
- Best for students long term vision ++
- Least impact on trees and maintain natural play space

- Best for the future kids/families attending school in the neighborhood
- If I had to choose – funding being major hurdle begrudgingly #3
- More opportunity for interesting architecture, safer with surface parking
- I'm disappointed the Bank St school was allowed to fall into disrepair, but given that happened I prefer Option 3 – less impact on natural areas and higher density. I like having an NLC
- I like option 3, but I am concerned about how busy it will be at the laiton intersection - my home
- Best for kids for the long term
- Best option for the community
- Ensuring most utilized space for play, school and availability for community
- Please knock down the dangerous old school building, it's an eyesore!
- Modern school with childcare please
- Build a Bank st that looks like the original 1900 one
- Seems the best long term option for children and families, who will use the school 10 months a year.
- Like this one but understand that Leighton will be pedestrianized
- Build a Bank St that looks like a spaceship
- Option 3 – we need to be building to meet our needs now and in the future
- The “traditional” construction should incorporate all intended uses for play, the layout and design.
- Can we build a new school that looks like our beloved Bank St School
- Wish we had info on timelines, Not the best way to find out your kid starts Grade 3 in 4 weeks
- Where will the kids go during the building phase?
- Option 3 – Thinks long term – new school = new opportunities. Make sure there is enough parking for staff
- Timelines? Too much parking? Step code? Net zero? Underground parking?
- This option seems to have a better long term goal in mind

5.0 Neighbourhood Learning Centre

- Activity and Game Space = 7
- Adult Learning = 9
- Before and after school care = 17
- Community Kitchen = 18
- Community Sports Storage = 0
- Enhanced Indoor Gymnasium = 12
- Health Service Space = 10
- Multi-purpose space (exercise room / large meetings)= 19
- Performance Space = 8

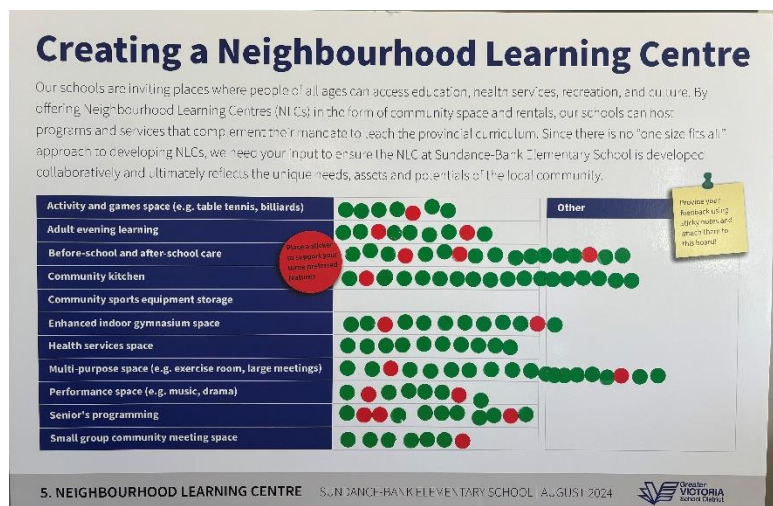

- Seniors Programming = 11
- Small Group Community Meeting Space = 7

6.0 Thank you! Any other feedback?

- I agree, children and families are the priority over aesthetics. The individuals who learn and work in this school need to be heard. We need adequate classroom space and outdoor play space please. People who will actually use the school or will in the future should get priority in terms of what they want in a new school. We should not keep an old building for aesthetics / nostalgia since that is the worst option for students.
- I am concerned about how long this will take – will my children need to move school while this is happening.
- Cost of heritage architecture, remediation – first sign? Multiply by at least five
- I'd rather see a sea of portables until money is found to do it right and save Bank School.
- For heritage folk, I need to ask, Did your children have to worry about having enough space in the school they went too?
- We need more pricing information for all options.
- Yes wondering timelines and where kids will be during the construction. Please explain.
- I would like a comprehensive presentation – too many talking heads – now more discussions collectively
- Use school building as an emergency center when earthquake arrives. Where else is there a facility for overflow. School storage for emergency supplies there are none.
- If every other development in the city is increasing density, why not a new school, so we can save the beloved heritage building AND save existing greenspace? Also lets build a 100% LEED certified green building for new school on footprint of this ugly, cinder-block Sundance school.
- Build year 3000 spaceship!
- Where would kids be moved to during construction. Option one agree
- Love Option 3 – with smaller footprint and better parking
- Parking is a major concern in this area. Fell St is very narrow and is a difficult street for fire trucks emergency to navigate. Should not be parking on both sides, residential only!
- City needs to stop waffling and commit to a plan – this project is essential, plus costs are only to continue to rise
- Save 1900 school
- Bank Street School is an iconic part of South Jubilee. If it cannot be preserved pay homage in new building.

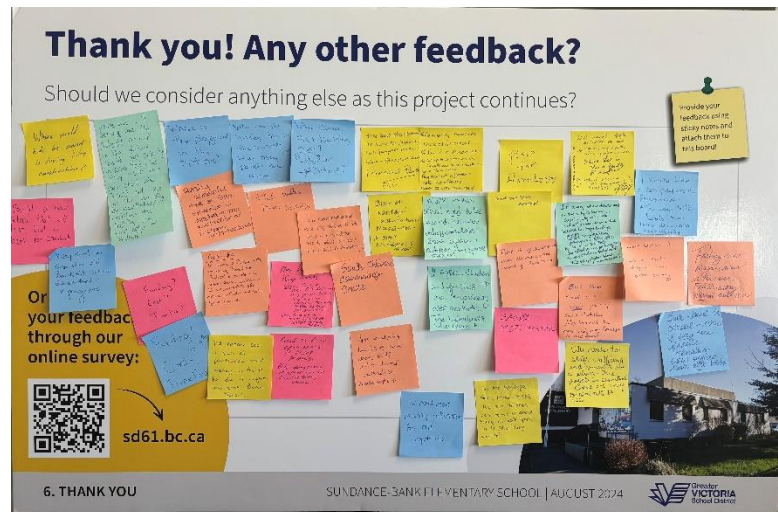

- Save Bank St school – even if only the façade remains. SD61 offices have old building.
- There is no discussion about environmental impact of the options.
- South Jubilee Community Center
- Very sad to see the old Bank Street school demolished - ? progress
- Build a new school that will last, that is best for students
- Really unhelpful that so little intention is directed to the protection of historic architecture
- Where is the playground in the options?
- Place for homeless
- Good to keep open space if treed properly. Building dangerous if left as is when expected quake arrives.
- Completely renovate bank street school. Join it to sundance. Go up to 3 stories in Sundance to accommodate more classrooms. Playfield not affected – Oaks not affected – Better environmentally.
- Make Bank St school the center for daycare, multipurpose room and before and after school care. Like Option 1
- More trees, keep roads, electric cars, and 2 door self-driving make greatly bike use, no additional expenditure and especially same direction bike lanes – learn from China, huge bike roads, change roads from cars.
- Option #4 – Preserve or restore the existing Bank St. school, build an extra building is accommodate the learning center and extra space needed
- Who owns Bank building now? City or District?
- Funding? Costs? Timeline? Option 1
- Funding? Costs? Timeline?
- The laiten intersection
- Why are you holding this in the summer, when many people are away.... Agree with Option 1

Appendix D: Online Survey



Sundance-Bank Elementary School Feedback Survey

Thank you for your interest in the future of Sundance-Bank Elementary School. Your feedback will help inform which expansion option will be considered to address current challenges that the school is facing such as enrolment increases, facilities conditions, and seismic safety requirements. We would also like your help to prioritize features within the school's new Neighbourhood Learning Centre.

This survey opens on August 7 and closes on August 31 at 11:45pm (extended deadline). Your response to the survey will be anonymous and all responses received will be compiled and reviewed by the Board of Education.

The Greater Victoria School District wishes to recognize and acknowledge the Esquimalt and Songhees Nations, on whose traditional territories, we live, we learn, and we do our work.

* Required

Introduction

1

Which of the below best describes your connection to the Greater Victoria School District? *

Select your answer

2

What are your hopes for a new Sundance-Bank Elementary School? *

Enter your answer

3

Do you have any concerns about expanding Sundance-Bank Elementary School? *

Enter your answer

Expansion Options

This section explores three expansion options we are considering for the future of Sundance-Bank Elementary School. We encourage you to read all three options before responding to each question of whether or not you are in support of each option.

Note: all options include an increase in capacity from 4 classrooms to 10 classrooms (240 capacity), a Neighbourhood Learning Centre, and an on-site child care. All options also require that the Sundance-Bank Elementary School building be demolished.

4

Option 1: Involves expanding Sundance-Bank Elementary School onto the adjacent Garry Oak Field.

Considerations:

- Existing Bank School remains with permanent 13m high safety barrier
- Impact on Garry Oak trees
- Less natural play space
- Smaller play field



Option 1: Expansion on Garry Oak Field Existing Bank School Remains

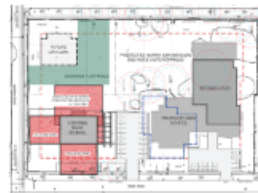

- ☐ Yes, I support Option 1
- ☐ No, I do not support Option 1

5

Option 2: Involves demolishing the existing Bank School and expanding Sundance-Bank Elementary School by way of modular building units on the property.

Considerations:

- Demolition of Bank School
- Some impact to Garry Oak trees
- Covered parking below building
- Natural play area retained
- Modular units built quicker
- Potential future maintenance costs



Option 2: Expansion on Bank School Site Modular Construction (Demolition of Bank School)

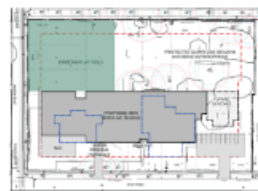

- ☐ Yes, I support Option 2
- ☐ No, I do not support Option 2

6

Option 3: Involves demolishing the existing Bank School and expanding Sundance-Bank Elementary School on the Bank School site through traditional construction means.

Considerations:

- Demolition of Bank School
- Least impact to Garry Oak trees
- More natural play area available



Option 3: Expansion on Bank School Site Traditional Construction (Demolition of Bank School)

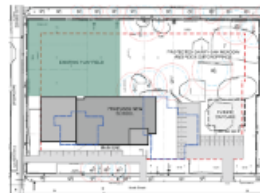

- ☐ Yes, I support Option 3
- ☐ No, I do not support Option 3

Neighbourhood Learning Centre



Our schools are inviting places where people of all ages can access education, health services, recreation, and culture. By offering Neighbourhood Learning Centres (NLCs) in the form of community space and rentals, our schools can host programs and services that complement their mandate to teach the provincial curriculum. This model promotes strong school-community partnerships to better meet the needs of children, families, and the whole community.

Since there is no "one size fits all" approach to developing NLCs, we need your input to ensure the NLC at Sundance-Bank is developed collaboratively and reflects the needs, assets and potential of the local community.

7

What amenities would you be interested in seeing included in the Neighbourhood Learning Centre located within the upgraded Sundance-Bank Elementary School? Select your top three priorities.

Please select 3 options.

- ☐ Activity and games space (e.g. table tennis, billiards)
- ☐ Adult evening learning
- ☐ Before-school and after-school care
- ☐ Community kitchen
- ☐ Community sports equipment storage
- ☐ Enhanced indoor gymnasium space
- ☐ Health services space

- ☐ Health services space
- ☐ Multi-purpose space (e.g. exercise room, large meetings)
- ☐ Performance space (e.g. music, drama)
- ☐ Senior's programming
- ☐ Small group community meeting space
- ☐ Other

8

Do you have any other feedback or considerations for the future Neighbourhood Learning Centre?

Enter your answer

Conclusion

9

How might we keep you informed of the process as we continue planning for Sundance-Bank Elementary School? Select all that apply.

- ☐ Email
- ☐ District website (www.sd61.bc.ca)
- ☐ School website
- ☐ School newsletter
- ☐ Social media (Facebook and Instagram)
- ☐ Newspaper
- ☐ Radio
- ☐ Television news (i.e. media coverage)
- ☐ Flyers
- ☐ Other

10

Do you have any other feedback to provide?

Enter your answer

60-Word Word Cloud (“school” and “building” excluded):

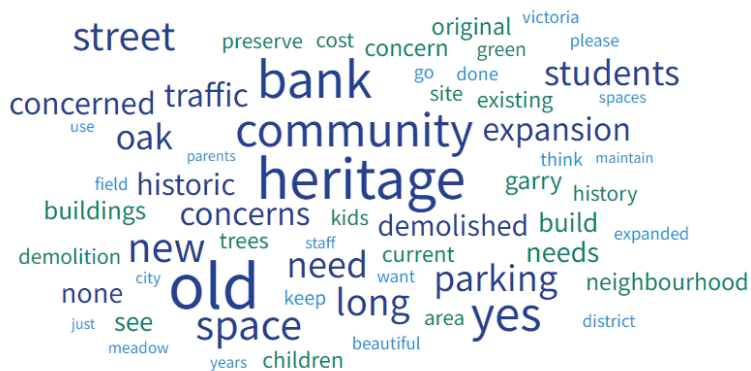

Option 1: Involves expanding Sundance-Bank Elementary School onto the adjacent Garry Oak Field.

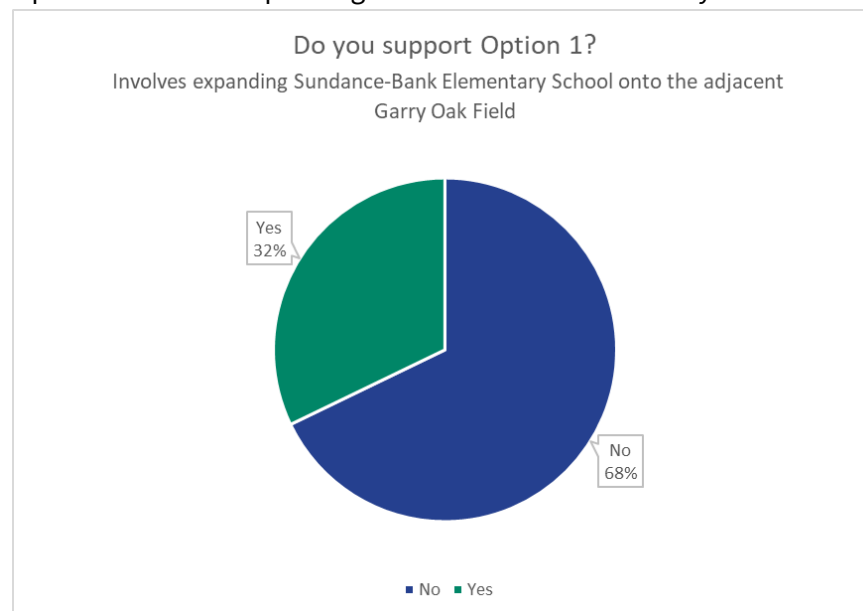

Question 5 [Multiple Choice]:

Option 2: Involves demolishing the existing Bank School and expanding Sundance-Bank Elementary School by way of modular building units on the property.

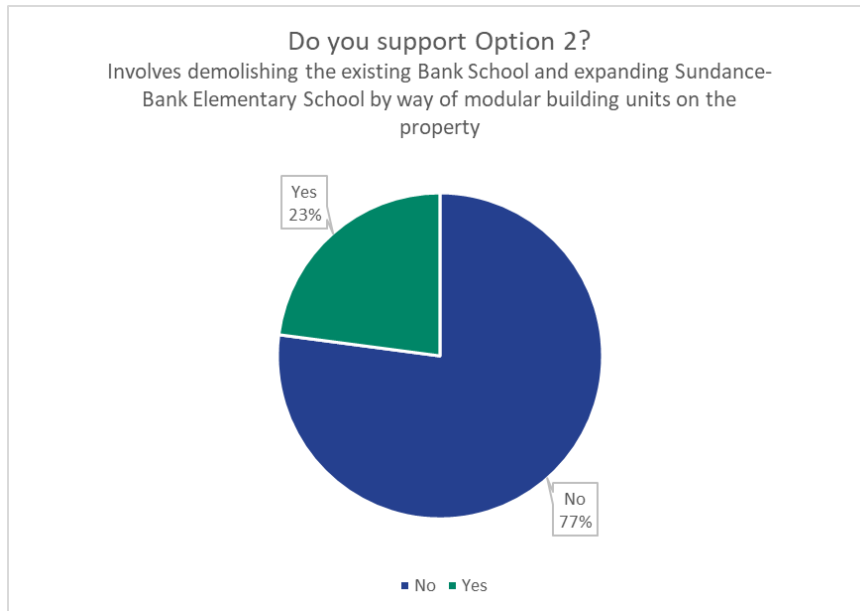
**Question 6 [Multiple Choice]:**

Option 3: Involves demolishing the existing Bank School and expanding Sundance-Bank Elementary School on the Bank School site through traditional construction means.

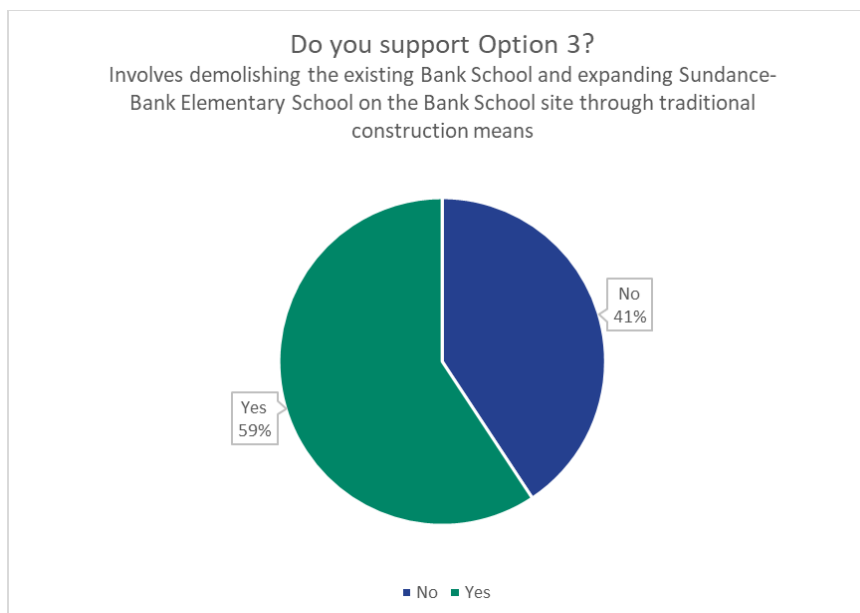

SECTION THREE

Question 7 [Multiple Choice, Select Up to Three]:

What amenities would you be interested in seeing included in the Neighbourhood Learning Centre located within the upgraded Sundance-Bank Elementary School? Select your top three priorities.

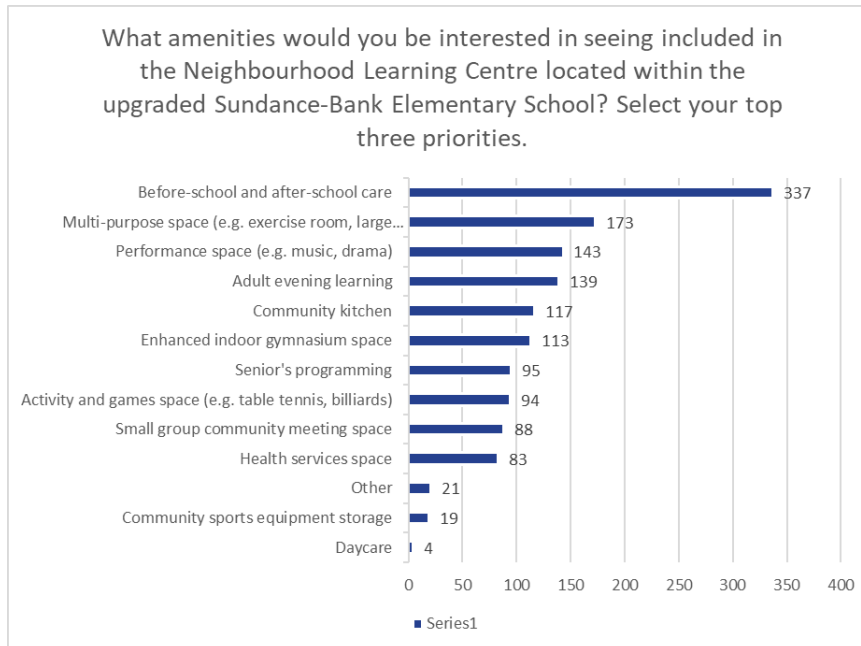

Question 8 [Open Text]:

Do you have any other feedback or considerations for the future Neighbourhood Learning Centre?
60-Word Word Cloud ("school" and "building" excluded):

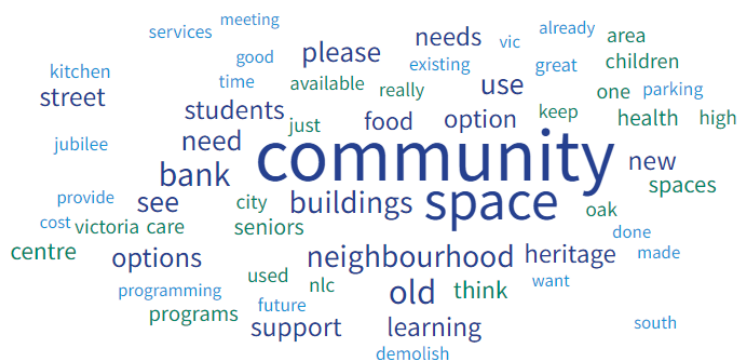

How might we keep you informed of the process as we continue planning for Sundance-Bank Elementary School?
Select all that apply.

A horizontal bar chart with blue bars representing the number of responses for each communication method. The x-axis is labeled from 0 to 250 in increments of 50. The y-axis lists the communication methods. The bars are ordered from highest to lowest value. The data is as follows:

Communication Method	Count
Email	227
Social media (Facebook and Instagram)	191
District website (www.sd61.bc.ca)	189
Newspaper	130
Television news (i.e. media coverage)	88
School website	85
Radio	75
School newsletter	55
Flyers	50
South Jubilee Neighborhood Association...	24
Posters and Signage	4
Other	3