

# Child Care Studio Community Consultation

## Proposed Child Care Buildings and Parking Location

In 2018, the Greater Victoria School District (GVSD) applied to the Ministry of Children and Family Development to create new child care spaces on a number of Greater Victoria School District properties. The GVSD was successful in all its applications and received funding for a number of elementary school locations—Frank Hobbs, Doncaster, Macaulay, Victoria West, and Tillicum, to name a few. The Greater Victoria School District applied for further child care funding and was approved for two exclusive child care units at the Uplands campus (formerly Uplands Elementary School).

The child care units are built by GVSD employees, with two dry units attached to one wet unit that includes six bathrooms, storage, and a full kitchen as per the licensing requirements. The child care units will be licensed with both units offering full-time care for children ages 3-5. The child care area will have a dedicated fenced area for children with dedicated parking spots for child care staff and dedicated drop off / pick up parking for child care families. The funding allocated for parking will be used to improve the site's current parking lot to allow for better access, more spots, and improved bus access.

All child care spots will be open to the Uplands school staff first and the community at large second. The GVSD is still in the process of finalizing child care providers for the approved site and will not be taking waitlist applications. Please visit the following website for more information on child care providers, waitlist, and construction information:

<https://www.sd61.bc.ca/news-events/community/childcare-studios/>

The GVSD has started to consult the community on the proposed location for the child care units by meeting with school community members. The GVSD is wanting to extend consultation to the surrounding community. We welcome your feedback if you are interested. Please send feedback via email to [community@sd61.bc.ca](mailto:community@sd61.bc.ca) by November 18, 2022.

## Appendix A – Conceptual Design Layout for Child Care Site

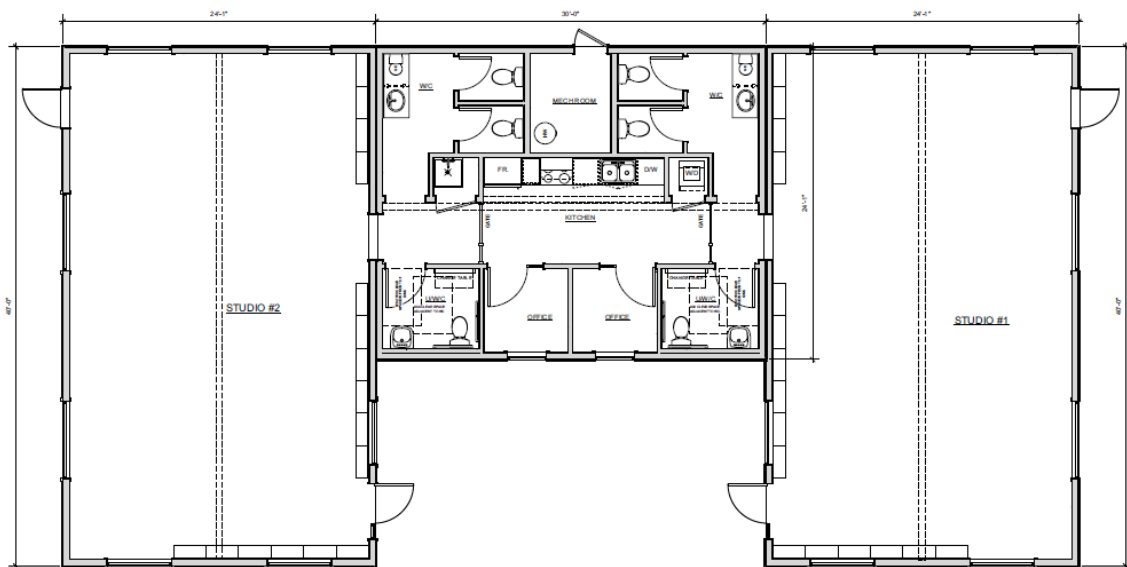

# Child Care Studio Community Consultation

## Appendix B – Proposed Location for Child Care Units and Parking on the Uplands Campus

The child care units will be located in the top corner of the property off Woodburn Ave. The units are shown in white with the proposed play space in green. Dedicated child care parking will be allocated within the current school lot. The current parking lot will be improved to allow for better bus access and to create further spots.

